



# Centromatic Centromatic-Micro

High Precision Centering

Fast and precise centering, compact design; process various geometries with standard tool; easily extendable to individual demands.

**satisloh**<sup>®</sup>

**Centromatic**  
fast & precise centering, compact design;  
process various geometries with standard tool;  
easily extendable.

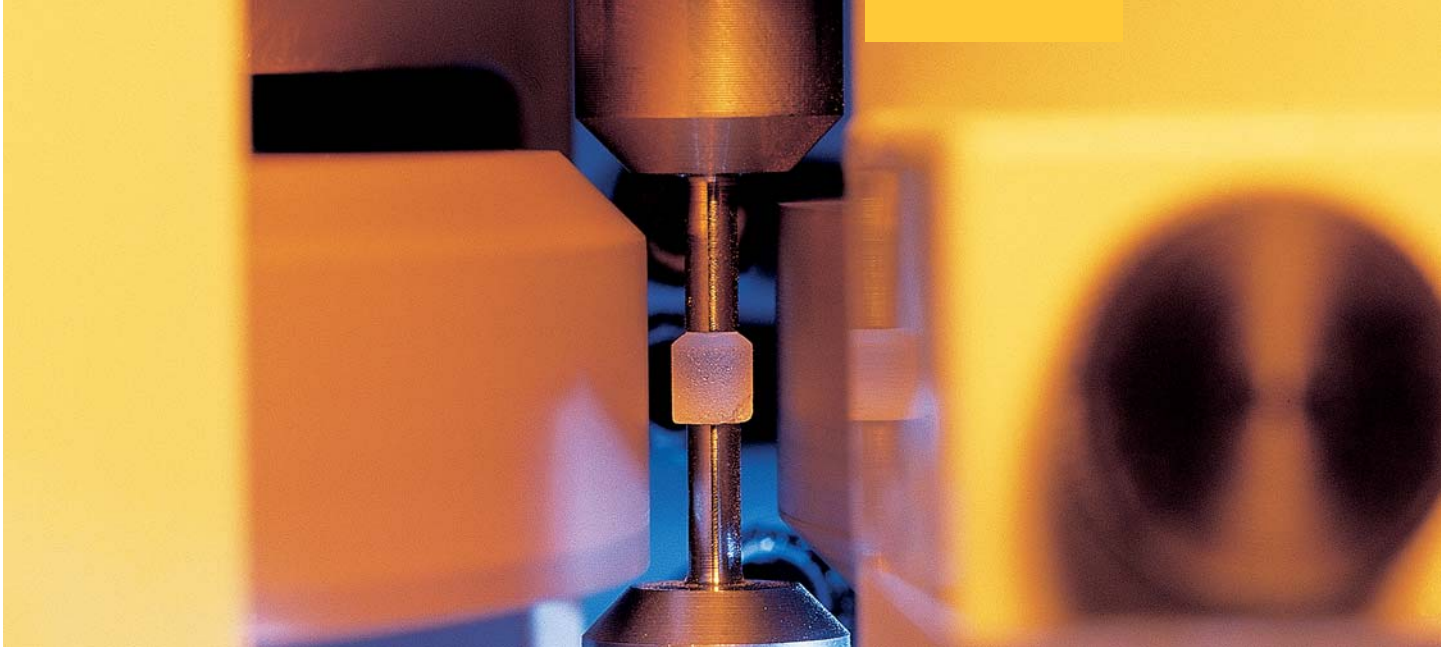

## Centromatic Centromatic-Micro

High precision centering for diameters 1 – 50 mm & 10 – 295 mm with up to 2 tool spindles for various geometries. Efficient processing including free-form edging and form edging (option) with automatic handling (option only CM-2).

### Working ranges

- Centromatic-Micro: 1 – 50 mm
- Centromatic: 10 – 295 mm

### Features

- 1 or 2 grinding tools
- Automatic processing with optional loading systems (only CM-2)
- Repeatable positioning accuracy: +/- 0.001 mm
- Automatical centre thickness compensation
- Laser alignment (option)

### Benefits

- High edging quality
- High productivity
- Fast processing using 2 tools

- Repeatable, accurate chamfers and steps by electronic center thickness compensation, the systems automatically detect lenses that can not be compensated
- Solid, vibration-free – machine base for constant high precision results
- Process complex lens and even non-circular shapes without tool change, using fully CNC-controlled rotational axes
- High versatility by modular design
  - 1 or 2 grinding tools
  - center thickness measuring system (option)
  - laser alignment system (options for SL versions)
- High process safety via integrated simulation mode
- Compact and stiff design

### High productivity and high precision

Enhance your production with the optional laser alignment system, the center-thickness measuring and the handling system (only CM-2).

Your benefit:

- Reduced labor costs
- Constantly high precision results
- Optimum productivity

### Fast change of centering bells and tools

Easy exchange centering bells using Hydro-expansion chucks (C-2). Fast and easy exchange grinding tools thanks to ABS (CM-2) or Emuge (C-2) systems.

### Easy to use

- Fast, easy programming using Windows™ based machine software
- Error-free and easy operation by graphical display of parameters
- Graphic simulation mode of complete process
- Continuous process during off-line programming via Emulation software
- Fast, precise lens alignment system using carbide centering bells
- Form & free-form software (optional) for different workpiece shapes

### Centromatic-Micro – extra sensitive clamping

The Centromatic-Micro provides highly sensitive and accurate clamping utilizing programmable (also mechanically adjustable) clamping pressure down to very low forces. This completely avoids any workpiece damages.

### Consumables, training & service

- Satisloh's Opticservice offers a wide variety of carbide centering bells, consumables & tools
- Comprehensive training programmes can be offered
- Fast & competent service provided by local service sites.



Precise & fast – accurate laser alignment system



Various centering bells available



Special applications – alternatively use collet chucks to process special lenses

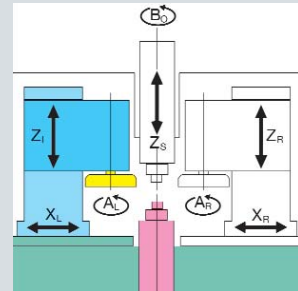

Flexible – modular design of Centromatic / Centromatic-Micro



Process even non-circular lens shapes with high precision

## Technical Information:

### Centromatic

- **Workpiece diameter:** 10 - 295 mm
- **Workpiece height:**  
0 - 67 mm standard  
20 - 90 mm (optional)
- **Tool diameter:**  
160 mm standard (for  $\varnothing$  range  
10 to 275 mm)  
125 mm (for  $\varnothing$  range 50 mm to 295 mm)
- **Energy requirements:** 8 kVA
- **Compressed air:** 6 bar
- **Dimensions (w x d x h):**  
1220 x 1350 x 1960 mm  
(2780 w. open cover) /  
48 x 53 x 77 inches  
(109 with open cover)
- **Weight:** 1900 kg / 4194 lb

### Centromatic-Micro

- **Workpiece diameter:** 1 - 50 mm  
with HS-Micro handling system: 5 - 40 mm
- **Workpiece height:**  
up to approx. 25 mm
- **Tool diameter:**  
120 mm
- **Energy requirements:** 3.5 kVA
- **Compressed air:** 6 bar
- **Dimensions (w x d x h):**  
720 x 926 x 1795 mm /  
28 x 36 x 70 inches
- **Weight:** 560 kg / 1236 lb

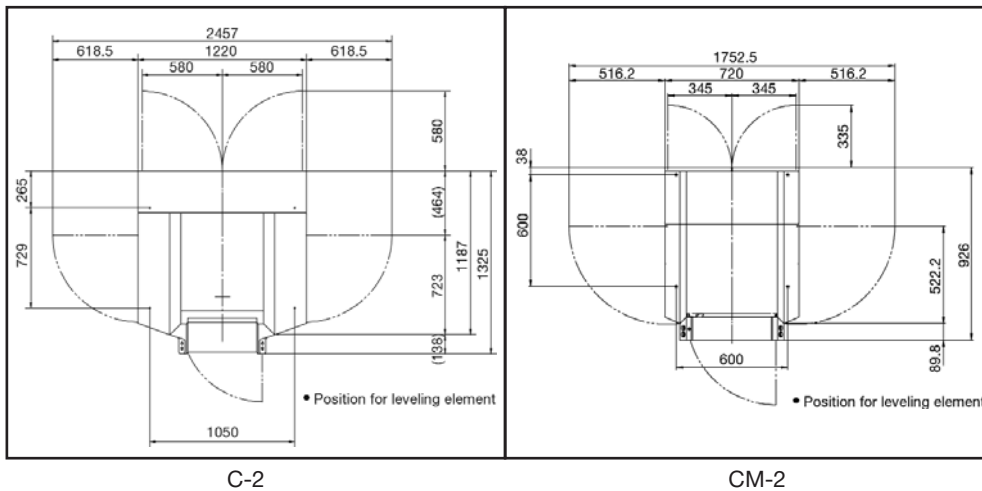

## Options & Accessories

- Automatic handling systems, e.g. HS-Micro
- Automatic center thickness compensation system
- Center thickness measuring system
- Laser alignment system
- Coolant system
- Chilling system
- Different sintered diamond tools, centering bells and consumables
- Software for non-round workpieces
- Software for free-form surfaces

# Contact

#### Satisloh AG

Neuhofstrasse 12  
CH-6340 Baar  
Switzerland  
Phone: +41 (0) 41766 16 16  
Fax: +41(0) 41766 16 10  
Mail: info@satisloh.com

www.satisloh.com

#### North America

Phone +1 262 255 6001  
E-mail info.usa@satisloh.com

#### Europe

Phone +49 (0) 6441 912 0  
E-mail info.de@satisloh.com

#### Asia

Phone +852 2756 7711  
E-mail info.asia@satisloh.com

#### Sales

#### Service

+1 262 255 6001  
service.usa@satisloh.com

+49 (0) 6441 912 555  
service.de@satisloh.com

+852 2756 7711  
service.asia@satisloh.com

satisloh®

